

1650 Houses For Sale



1304 Picotte
3-bedroom, 1.75-bath in great location. Single detached garage in rear. Sale price \$114,000. Joe Labarge America's Best Realty (605)661-7264.



162 Quarry Pines Drive
Price Reduced. 4-bedroom, 4-bath, 3-car garage on 1-acre. Incredible lake views! Call (605)661-2191 or (605)668-0192 after 5. For photos/info www.yankton.net/162quarry



204 Anchor Drive
\$119,900 Nice 3-bedroom 1-bath home. Oversized double garage, great neighborhood, move in ready! Erica Anderson Realty LLC (605)660-2992.



4-bedroom, 2-bath ranch style home. 2 car garage, finished basement. 3007 Francis. (605)661-0220 www.yankton.net/3007francis

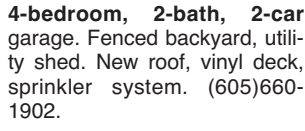

4-bedroom, 2-bath, 2-car garage. Fenced backyard, utility shed. New roof, vinyl deck, sprinkler system. (605)660-1902.



4-bedroom, 3-bathroom, ranch style. 2704 Pine. Double garage, \$235,000. (605)660-0305.

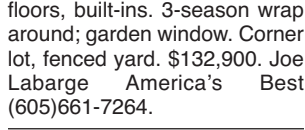

800 Locust
Craftsman style bungalow. 3-Bedroom, Classic bathroom. Original woodwork, oak wood floors, built-ins, 3-season wrap around; garden window. Corner lot, fenced yard. \$132,900. Joe Labarge America's Best Realty (605)661-7264.

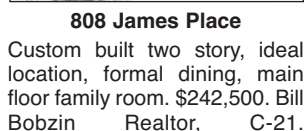

808 James Place
Custom built two story, ideal location, formal dining, main floor family room. \$242,500. Bill Bobzin Realtor, C-21. (605)661-0148.

Houses for sale or rent: One bedroom house, finished basement, garage. 2-bedroom house remodeled. Both reasonably priced, seller financing available. (605)661-1737.

1655 Mobile Homes For Sale

Mobile Homes For Sale as Affordable as Rent! Lakeside MHP. (605)668-2163

2-bedroom, 1973 Great shape, new carpet and linoleum. Appliances. Nice entry. Reduced Price! (605)661-0606.

2-Collector dolls, in boxes, \$10/each. Heritage Lace Ladies Shawl, Pretty. Still has tags, \$10. Die-cast Metal-1984 Ferrari GTO Model Car, in box, \$10. Large box water and wine glasses, \$10/all. (605)665-3201.

Couch good condition, blue with hide-a-bed, \$50. (605)661-3307 (605)661-2040.

Entertainment center 6'x6', oak finish, \$95. (605)665-0321.

Four P245-65/R17 tires, good condition \$70. Call (605)660-2087.

GE self cleaning island stove, white. Works well. \$100. (605)665-2275.

Prom Dress: Navy-blue, floor length, spaghetti straps, backless, ties in back, size 5/6, great condition, \$45. (before 5pm) 605-857-0680 or (after 5pm) 605-857-1057.

Prom Dress: Yellow, floor length, spaghetti strap dress with high-waist ruffled belt, bought new, worn once, Medium, \$70. If interested, (before 5pm) 605-857-0680 or (after 5pm) 605-857-1057.

Student computer desk, \$30. exercise ball, \$10. Dell printer, \$20. DVD/VCR stand, \$10. Plastic 3 drawer unit, \$8. (605)463-2495.

Whirlpool electric range, almond, good condition, works good, \$100. (605)665-0321.

1820 Give Aways
Free to Loving Home. Part Black Lab/Part Cocker-Spaniel. 3yrs. old. House-broken. Playful, but good with older kids. Has had most vaccinations. Her name is 'Shelby'. 605-857-0680.

1660 Acreage - Lots For Sale

152 (- or +) Tillable acres in Yankton County. Leona Sparks, Anderson Realty. (605)660-6078.

Numerous lots north of Hillcrest Golf Course-Ridgeway North development. Call Kirby Hofer (605)665-0524 or (605)660-1422.

O'Malley's Bar downtown Yankton \$299,000
Well established 3-story Yankton landmark. Price includes building, most contents and liquor license. Recent upgrades to roof, furnace and air conditioning. Call Connie Bornitz Achieve Realty (605)553-6908. www.achievest.com

Power reclining chair, excellent condition. \$275. Clean. (605)660-5225.

SAVE THE DATE! 2010 Yankton Annual Citywide Rummage Sales May 13, 14, 15, & 16 Watch your Yankton Daily Press & Dakotan for details!

1970's Bally Arcade system, complete with joy sticks and cassette games. \$25. (605)624-2985 leave message.

2TV's \$10/each. Dresser \$15; 5 pair of carpenter jeans size 16 \$5/each. Terry (605)660-2913

3 Prom dresses: 1 size 3/4 Hot Pink, \$33. 1 size 8 Black and white, \$33. 1 size 10 black and white, \$33. (605)665-6640.

YANKTON SCHOOL DISTRICT 63-3
NOTICE OF DEADLINE FOR VOTER REGISTRATION
Voter registration for the Yankton School District 63-3 School Board Election to be held on April 13, 2010, will close on the 29th day of March, 2010. Failure to register by this date will cause forfeiture of voting rights for this election. If you are in doubt about whether you are registered, check the Voter Information Portal at www.sdsos.gov or call the county auditor at 260-4400 X 0. Registration may be completed during regular business hours at the county auditor's office, municipal finance office, secretary of state's office, and those locations which provide driver's licenses, SNAP, TANF, WIC, military recruitment, and assistance to the disabled as provided by the Department of Human Services. You may contact the county auditor to request a mail-in registration form or access a mail-in form at www.sdsos.gov. Voters with disabilities may contact the county auditor for information and special assistance in voter registration, absentee voting, or polling place accessibility. Jason L. Bietz, Business Manager Yankton School District Estimated publishing cost per circulated copy \$0.002

YANKTON COUNTY 2009 EXEMPTION LIST
Isaac Walton League, Isaac Walton Addn SW4SE4 7-93-54, 100% CLUBHOUSE; Gayville Community Cemetery, Lt A Gayville 12-93-54 & Parcel starting @ pt 2rds S & 2 rds E of NW corner NW4 NW4, thence E20rds, thence S16rds, thence W20rds, thence N16rds to POB 12-93-54, 100% CEMETERY; Trinity Lutheran Church Cemetery Association, NE4 NE4 Cemetery 1-92-54, 100% CEMETERY; John A Leggett etux Revocable Trust, Turkey Creek Memorial Park Addn NE4 SW4 & SE4 NW4, 100% CEMETERY; Volin Cemetery Association, NE4 NW4 2.5 Acres 13-94-54, 100% CEMETERY; St John E. L. Church, NE4 NE4 Parcel (Roseberg Cemetery) 19-94-54, 100% CEMETERY; Vangen Norsk Evangelisk Lutherske Menighed, Parcel SW4 SE4 & Vangen Cemetery Addn 30-94-54, 100% CEMETERY; Hinseth, S etal, 165' X 264' & 825' X 660' Parcel NW4 (Cemetery) 3-95-54, 100% CEMETERY; SD Department of Game Fish & Parks & BroomTree Ministries, Tract 1 Marindahl Game Production Area SW4 7-95-54, 100% RECREATIONAL & RELIGIOUS; Broom Tree Ministries & State of SD Game Fish & Parks, Tract 2 Marindahl Game Production Area SW4 7-95-54, 100% 80 ACRES & 95% RELIGIOUS BLDGS; Trondhjem Evangeliske Lutherske Menighed, Lts A, B, C & D Trondhjem's SD 21-95-54, 100% RELIGIOUS;

1705 Items \$100 or Less
3+12+19

2010 Legal and Public Notices
3+12+19+26 & 4+2
State of South Dakota
County of Yankton: SS
In Circuit Court
First Judicial Circuit

Kipton Lyle Johnson, Plaintiff,
vs.
Amy Nichole Johnson, Defendant

Div # 09-761
SUMMONS
THE STATE OF SOUTH DAKOTA SENDS GREETINGS TO THE ABOVE NAMED DEFENDANT
YOU ARE HEREBY SUMMONED AND REQUIRED to answer the Complaint of the Plaintiff herein, a copy of which is hereto attached and herewith served upon you, and to serve a copy of your answer thereto upon the subscriber at his law office in the City of Yankton, South Dakota, within thirty (30) days after the completed service of this Summons upon you, exclusive of the day of such service, and if you fail to answer as above required, judgment by default may be rendered against you as demanded in the Complaint.
YOU ARE FURTHER NOTIFIED that this is an action for divorce, and, as provided by SDCL 25-4-34, this action cannot be heard, tried or determined by the Court until at least sixty (60) days have elapsed from the date of the completed service of the Plaintiff's Summons and Complaint in this action.

2010 Legal and Public Notices
Faith United Lutheran Church, Lt C-1 Zion Lutheran Church exc Lt R3 SE4 33-95-54, 100% RELIGIOUS SERVICES; Zion Cemetery Association, Inc, Lt C-2 Zion Lutheran Cemetery exc Lt R3 33-95-54, 100% CEMETERY; Norsk Evangelisk Lutheran Meldahl Church, Parcel commencing @ pt on E line of NE4 5-96-54 14 rds from SE corner of NE, thence W16rds, thence N20rds, thence E16rds to line of said NE4, thence S20rds to POB & Parcel commencing @ SE corner NE4 5-96-54 extending N14rds, thence W16rds, thence S14rds, thence E16rds along S4 line to POB, 100% CEMETERY; Turkey Valley Baptist Cemetery Association, Cemetery Tracts 1 & 2 NE4 NE4 23-96-54, 100% CEMETERY; Turkey Valley Lutheran Church, 298' X 298' Parcel in NW corner NW4 NW4 24-96-54, 100% CEMETERY; Aggergaard Memorial Cemetery aka Hillcrest Cemetery, Commencing @ pt 1690' S 89 degrees 20 min W of SE corner 36-96-54, thence S89 degrees 30 min W 660', thence N0 degrees 30 min W 330', thence N 89 degrees 20 min E330' to POB & Lt H, 100% CEMETERY; Broom Tree Farm Retreat Ministries, NE4 12-95-55, 95% MINISTRY MEETINGS; Walshtown Community Church, E132' S82.5' SE4 SW4 14-95-55, 100% CEMETERY; Walshtown Township, NW4 SE4 Parcel 2.25 Acre 17-95-55, 100% DRIVEWAY; Roman Catholic Cemetery, SE4SE4 Parcel 1.135 Acres 27-95-55, 100% CEMETERY; Elim Cemetery Association, Parcel 4.21 Acre SE4 NE4 8-96-55, 100% CEMETERY; Our Redeemer Lutheran Church, Lts L-1 and L-2 W1/2NW1/4 & L-3 Govt Lt 2 Exc E1109.21' Lt L-2 19-96-55, 50% CHURCH & PARSONAGE; Sorensen, Jens P & Mary, Parc beginning at NE corner of SE4 SE4 running W5rds, thence S4rds, thence E5rds, thence N4rds to POB 22-96-55, 100% CEMETERY; St Columba Church, Mayfield, Blocks 1 & 2 St Columba Addition 34-96-55, 100% RELIGIOUS & SOCIAL; Marina Dell Estates Road District, Parcel D Blk 3 Marina Dell Two SD 17-93-56, 100% ROADS; Habitat For Humanity of Yrk Co, Lts 10 & 11 Blk 2 & Lts 13, 14 & 17 Blk 3 Mayer's Addn 22-93-56 & E2 E2 Lt 47 exc S75' Dakota National S/D & Lts 16 & 17 Blk 8 Lower Yankton 100% HABITAT HOUSING; Lewis & Clark Behavioral, Bldg on Tract 3 less Lt 1 of said Tract 3 being a s/d of SW4 36-94-56, 100% HEALTH CARE; Beth Norsk Evangelical Lutheran Menighed, A tract 240' N&S & 50' E&W in the NW corner of N2 SE4 & a parc commencing at NE corner SW4 & running S14rds, thence W6rds, thence N14rds, thence E6rds to POB 1-95-56, 100% CEMETERY; Bethlehem Lutheran Church, N42' N2 SW4 (2.55 A.) 1-95-56, 100% CEMETERY; Martinus Lutheran Church, Parcel in SW4 SW4 14-95-56, 100% RELIGIOUS; Mueller Family Cemetery, 2 Acres in SW4 NW4 18-95-56, 100% CEMETERY; Sigel Parish Hall, 67rds X 12rds Parcel NE4 NE4 23-95-56, 100% RELIGIOUS; Martinus Cemetery, Inc, Martinus Lutheran Cemetery 26-95-56, 100% CEMETERY; Calleson, Elizabeth etal, Klasi Family Cemetery 30-95-56, 100% CEMETERY; Peace Christian Reformed Church, E163.50' N21.9 Rds of E21.9 Rds NW4 9-96-56, 100% CEMETERY; Bethlehem Norsk Evangelisk Lutheran Church, A strip of land commencing at the SW corner 11-96-57, thence N20rds, thence E6rds, thence S20rds, thence W6rds to the POB, 100% CEMETERY; Bethlehem Lutheran Church, Commencing at the SW corner of SW4, thence N390', thence E330', thence S396', thence W330' to POB 14-96-56, 100% CEMETERY; Maple Grove Cemetery Association, Parcel 130' X 140' SE4 SW4 5-93-56, 100% CEMETERY; Sioux Council BSA, S2 SE4 8-93-57, 100% ADMINISTRATION FACILITY; House of Mary Shrine, Lt B-44 Fairview Heights 13-93-57 & Lt 1 Exc E75' & Lts 1A, 2, 2A & 13 Blk 5 & Lt 1a1 Blk 7 & Lt B-47 English Heights & Timber Lane Golf Course 14.93 acres E1/2 & Timberland Park exc Parcel A English Heights & Parcel A Timberlane Park English Heights

2010 Legal and Public Notices
13-93-57, 100% RELIGIOUS; Polish Catholic Congregation, Parc commencing @ NE corner NE4, thence running W20rds, thence S80rds, thence E20rds, thence N80rds to POB 5-94-57, 100% CEMETERY; Public Cemetery, Parcel 104' X 792' NW4 11-94-57, 100% CEMETERY; Roman Catholic Church St Wenceslaus, Parc beginning @ pt lrd S of center of Sec 33-94-57 thence running S33rds, thence E48rds, thence N33rds, thence W48rds to POB NW4 SE4, 100% CEMETERY; St John The Baptist Church of Lesterville, Lt X NW4 NE4 21-95-57, 100% RELIGIOUS; Civil Cemetery Association, Commencing @ pt 28.5' E of quarter sec corner common to sec 28 & 29-95-57 & running N18.5rds, thence W8rds, thence S20rds, thence E8rds, thence N1.5rds to POB, 100% CEMETERY; Our Savior's Evangelical Lutheran Church of Yankton, Beginning @ SE corner SW4 NW4, thence running about 52 Rds NW for POB, thence nearly N16rds, thence W6rds, thence S20rds thence E12rds to POB 4-96-57, 100% CEMETERY; Our Savior Lutheran Congregation, Stone Church Addn NE4 NE4 9-96-57, 100% RELIGIOUS; James River Norske Evagelecke Lutheric, Parc 4.77 Acres SW4 NW4 Cemetery 11-96-57, 100% CEMETERY; Zion American Lutheran Church, E600.81' W1762.74' of S725.01' of SW4 28-96-57, 100% CEMETERY; German Reformed Odessa Church, 115.5' X 82.5' SW4 NE4 31-96-57, 100% CEMETERY; Cemetery, W16rds S20rds SW4 SW4 Exc E8rds W16rds S20rds exc Lt H1 & exc Lt R-1 SW4 SW4 31-96-57, 100% CEMETERY; Hoffnunge Reformed Church Gemeinde, 330' X 330' SE4 NE4 34-96-57, 100% CEMETERY; Community Center of Gayville, N100' Lt 12 exc W25' & all Lts 13 & 14 Blk 10 Original Town Gayville, 100% MEETING ROOM; Lutheran Church, Lts 8 & 9 Blk 15 & Lts 8 & 9 Blk 16 Original Town Gayville, 100% PARSONAGE & CHURCH; Gayville-Volin United Methodist Church, E2 Lt 11, All Lts 12, 13 & 14 Blk 16 Original Town Gayville, 100% CHURCH; Ermie Pecena Community Center, Lts 13-15 Blk 5 & Lt 6 Blk 6 Original Town Lesterville, 100% COMMUNITY CENTER & CITY PARK CENTER; Lesterville Fire Department of Lesterville, W80' Lts 21 & 22 Blk 5 Original Town, 100% FIRE DEPT; Lesterville Community Club, Lts 17 & 18 Blk 6 Original Town Lesterville, 100% PARK AND SHELTER; St John Baptist Catholic Church, Lts 2-12 Kappel Addn Lesterville, 100% PARSONAGE; Roman Catholic Parish, Lts 1-5 Blk 1 Wagners Addn Lesterville, 100% STORAGE GARAGE; Harvest Independent Baptist Church, Outlots G & H SE4 SE4 Mission Hill Outlots, 100% RELIGIOUS; Mission Hill Cemetery Association, Outlot F SE4 SE4 Mission Hill Outlots & N474.8' Outlot 1 Mission Hill Outlots, 100% CEMETERY; Lutheran Church, Outlot J & E75' Outlot K Mission Hill Outlots, 100% CHURCH; ZCBI Lodge, Lts 16-20 Blk 6 Original Town Utica, 100% LODGE; City of Volin, Lts 1 & 2 & W11' Lt 3 Blk 13 Volin Addn, 100% FIRE DEPT; Wintz & Ray Funeral Home & Cremation Service Inc, Lt 3 Exc E187' S361.4' & Exc N92' Lt 3, All Lt 4 Blk 1 Airport Acres, 100% CEMETERY; Sacred Heart Health Services, Avera Sacred Heart Senior Living Campus Addition 14-93-56, 100% ASSISTED LIVING; Sacred Heart Hospital, Hospital Lt D & D1 Benedictine Addn, 80% WELLNESS & REHAB CTR/ 94.758% BENEDEICTINE CTR/ 81.813 % PROFESSIONAL OFFICE; Mount Marty Hospital Association, Hospital Lts A1, D2, D3, D4, & E1/2 Benedictine Hilltop Addn, 100% PARKING LOT; Benedictine Convent of the Sacred Heart, Ryken Tr 2, Ryken Tr 3 East of 1/16th line & that part of Tr 4 lying west of div line between Govt Lots 2 & 3 13-93-56 & Monastery Lts A2, B, B1, C, C1,C2,C4,C5 & F Benedictine Hilltop Addn & Monastery Lt E1 & Lts X & Y Benedictine Addn, 100% RELIGIOUS EDUCATION & Parcel 44 Parcels 13-93-56, 100% LIVING QUARTERS; Yankton Baptist Church, Lt F B.K.L Addition, 100% PARSONAGE; The Dakota Conference Corp. of Seventh-day Adventists, Lts 4 & 5 Block 70 Central Yankton, 100% RELIGIOUS; Calvary Baptist Church, Wal-Mart Tract A Lt 5 Flake's SD, 100% CHURCH RELATED; Presbyterian Church, Lts 3 & 4 Gamco's Addn, 100% RELIGIOUS; Riverview Park Reformed Church, W100' S185' Parcel B O/L B & Parcel C O/L B exc E100' Harris Outlots, 100% RELIGIOUS; Sacred Heart Catholic Church, Lt 18 Blk 4 Lower Yankton, 100% RELIGIOUS; Yankton Area Arts Association, S32' Lt 5 Blk 5 Lower Yankton, 100% ART ADVOCACY, GALLERY & PROGRAMMING; Roman Catholic Church, Lts 6,7 & N2' Lt 8 Blk 5 Lower Yankton, 100% PARKING LOT/CHURCH/RECTOR & S2 SW4 NW4 & Parcel in NW4 SW4 6-93-55, 100% RELIGIOUS; Roman Catholic Church of the Sacred Heart, Lt 16 Blk 5 Lower Yankton, & W2/3 of Lts 8 & 9 Exc N17.6' W2/3 of Lt 8 Blk 19 Lower Yankton, 100% CHURCH; Antioch Baptist Church, W3 Lts 8 & 9 Blk 6 Lower Yankton, 100% CHURCH; Roman Catholic School, Lts 1-9 Blk 20 Lower Yankton, 100% EDUCATION & RELIGIOUS (SCHOOL); Heritage Homes Inc, N1/2 L14 & all Lts 15-17 Blk 20 Lower Yankton, 100% HISTORICAL VIEWING; Abundant Life Ministries, Lts 17 & 18 Blk 67 Lower Yankton, 100% CHURCH; First Assembly of God Church, Lt 1 Blk 2 Matuska's Addn, 100% PARSONAGE; Prince of Peace Ev. Lutheran Church, Blk 5 Mitchell Steward 3rd Addn, 100% CHURCH & PARSONAGE; Planning & Development Dist III, W112' Lt 1 Pal Christensen Addn, 100% GOVERNMENTAL ENTITY; Club 12-24, E1/2 Lts 1 & 2 Blk 1 Pierses S/D Blk 24 & Lts 17 & 18 Blk 1 Pierses S/D Blk 24 & Lts 1-12 Blk 2 Pine Acres & Lts 1-12 Blk 3 & Lts 1-12 exc W50' Lts 11 & 12 Blk 4 & Lts 2-5 Blk 5 & Lts 2-16 Blk 6 Pine Acres, 100% 4-H GROUNDS MEETING ROOMS & LAND; Mount Marty Hospital Association, Lts 1,2 & 3 Blk 1 Redmonds S/D, 100% CANCER CENTER; Sacred Heart Health Services, W40.3' Lts 16, 17 & 18 Blk 1 Redmonds S/D, 100% CANCER CENTER; Kingsway Christian Church, Blk 4 Exc W20' N138.5' Riverview Park, 100% CHURCH & PARSONAGE; First Assembly of God Church, Tract C Steve Larson Addn, 100% CHURCH; Yankton Baptist Church, Lts 11-20 Blk 2 Taylor & Sargent's, 100% PARSONAGE & MEETING HOUSE; St Benedict Catholic Church, E648' S609.22' Lt 1 Blk 1 & Lt 6 Blk 2 Tielkes S/D, 100% CHURCH & PARKING & PARSONAGE; Ernest Bowyer Post #791VFW, N16' Lot 11 & all Lt 12 & S 41.10' Lt 13 Blk 13 Todds Addn, 100% LODGE; Scottish Rite Temple Association, Lts 15-18 Blk 24 Todds Addn, 100% LODGE; Lewis and Clark Theater Co, S23' Lt 2 & all Lt 3 Blk 26 Todds Addn, 100% THEATRE; Loyd Order of Moose Inc, Lt 6 Blk 26 Todds Addn, 75% LODGE; Yankton Womens/Childrens Center, E1/2W1/2 Lt 10 & E1/2 W1/2S1/2 Lt 11 Blk 35 Todds Addn, 100% FAMILY VISITATION CENTER; Yankton Homeless Shelters, W1/2E1/2 Lt 10 & W1/2E1/2S1/2 Lt 11 Blk 35 Todds Addn, 100% LIVING QUARTERS; Women's Children Center, Lt 4 & N3' Lt 5 Blk 48 Todds Addn, 100% LIVING QUARTERS; Faith Christian Fellowship of Yankton, E94' Lts 10 & 11 Blk 48 Todds Addn, 100% RELIGIOUS; United Church of Christ, Lt 5 Blk 49 Todds Addn, 100% RELIGIOUS; United Church of Christ Congregational, Lts 7-9 Blk 49 Todds Addn, 50% RELIGIOUS EDUCATION; First Congregational Church of Yankton, Lts 10, 11 & 12 Blk 49 Todds Addn, 100% RELIGIOUS; Christ Church Episcopal Inc, Lts 1 & 2 Blk 50 Todds Addn, 100% CHURCH PARKING; Christ Episcopal Church, N2 Lt 15, All Lts 16, 17 & 18 Blk 50 Todds Addn, 100% CHURCH & Clark Mental Health Center, Lts 1-7 Blk 1 Tripp & Harris, 100% MEETING ROOM; Lewis & Clark Behavioral Health, E30' Lt 9 & all Lts 10-12 Blk 1 Tripp &

2010 Legal and Public Notices
South Dakota law provides that upon the filing of a Complaint for divorce or separate maintenance and upon personal service of the Complaint and Summons on the Defendant, a Temporary Restraining Order shall be in effect against both parties until the final Decree is entered, the Complaint is dismissed, or until further Order of the Court. Either party may apply to the Court for further temporary orders or modifications or revocation of the Order.

TEMPORARY RESTRAINING ORDER BY ORDER OF COURT, YOU AND YOUR SPOUSE ARE:
A. Restrained from transferring, encumbering, concealing or in any way dissipating or disposing of any marital assets, without the written consent of the other party or an order of the Court, except as may be necessary in the usual course of business or for the necessities of life. You are to notify the other party of any proposed extraordinary expenditures and to account to the Court for all extraordinary expenditures made after the Temporary Restraining Order is in effect;
B. Restrained from molesting or disturbing the peace of the other party.

Dated at Yankton, South Dakota on this 10th day of December, 2009.

Dana J. Gaskins
Attorney for the Plaintiff
KABEISEMAN & POLLARD
PO Box 837
505 Broadway Avenue
Yankton, South Dakota 57078-0837
(605)665-5222

3+19
YANKTON COUNTY 2009 EXEMPTION LIST
Isaac Walton League, Isaac Walton Addn SW4SE4 7-93-54, 100% CLUBHOUSE; Gayville Community Cemetery, Lt A Gayville 12-93-54 & Parcel starting @ pt 2rds S & 2 rds E of NW corner NW4 NW4, thence E20rds, thence S16rds, thence W20rds, thence N16rds to POB 12-93-54, 100% CEMETERY; Trinity Lutheran Church Cemetery Association, NE4 NE4 Cemetery 1-92-54, 100% CEMETERY; John A Leggett etux Revocable Trust, Turkey Creek Memorial Park Addn NE4 SW4 & SE4 NW4, 100% CEMETERY; Volin Cemetery Association, NE4 NW4 2.5 Acres 13-94-54, 100% CEMETERY; St John E. L. Church, NE4 NE4 Parcel (Roseberg Cemetery) 19-94-54, 100% CEMETERY; Vangen Norsk Evangelisk Lutherske Menighed, Parcel SW4 SE4 & Vangen Cemetery Addn 30-94-54, 100% CEMETERY; Hinseth, S etal, 165' X 264' & 825' X 660' Parcel NW4 (Cemetery) 3-95-54, 100% CEMETERY; SD Department of Game Fish & Parks & BroomTree Ministries, Tract 1 Marindahl Game Production Area SW4 7-95-54, 100% RECREATIONAL & RELIGIOUS; Broom Tree Ministries & State of SD Game Fish & Parks, Tract 2 Marindahl Game Production Area SW4 7-95-54, 100% 80 ACRES & 95% RELIGIOUS BLDGS; Trondhjem Evangeliske Lutherske Menighed, Lts A, B, C & D Trondhjem's SD 21-95-54, 100% RELIGIOUS;

2010 Legal and Public Notices
13-93-57, 100% RELIGIOUS; Polish Catholic Congregation, Parc commencing @ NE corner NE4, thence running W20rds, thence S80rds, thence E20rds, thence N80rds to POB 5-94-57, 100% CEMETERY; Public Cemetery, Parcel 104' X 792' NW4 11-94-57, 100% CEMETERY; Roman Catholic Church St Wenceslaus, Parc beginning @ pt lrd S of center of Sec 33-94-57 thence running S33rds, thence E48rds, thence N33rds, thence W48rds to POB NW4 SE4, 100% CEMETERY; St John The Baptist Church of Lesterville, Lt X NW4 NE4 21-95-57, 100% RELIGIOUS; Civil Cemetery Association, Commencing @ pt 28.5' E of quarter sec corner common to sec 28 & 29-95-57 & running N18.5rds, thence W8rds, thence S20rds, thence E8rds, thence N1.5rds to POB, 100% CEMETERY; Our Savior's Evangelical Lutheran Church of Yankton, Beginning @ SE corner SW4 NW4, thence running about 52 Rds NW for POB, thence nearly N16rds, thence W6rds, thence S20rds thence E12rds to POB 4-96-57, 100% CEMETERY; Our Savior Lutheran Congregation, Stone Church Addn NE4 NE4 9-96-57, 100% RELIGIOUS; James River Norske Evagelecke Lutheric, Parc 4.77 Acres SW4 NW4 Cemetery 11-96-57, 100% CEMETERY; Zion American Lutheran Church, E600.81' W1762.74' of S725.01' of SW4 28-96-57, 100% CEMETERY; German Reformed Odessa Church, 115.5' X 82.5' SW4 NE4 31-96-57, 100% CEMETERY; Cemetery, W16rds S20rds SW4 SW4 Exc E8rds W16rds S20rds exc Lt H1 & exc Lt R-1 SW4 SW4 31-96-57, 100% CEMETERY; Hoffnunge Reformed Church Gemeinde, 330' X 330' SE4 NE4 34-96-57, 100% CEMETERY; Community Center of Gayville, N100' Lt 12 exc W25' & all Lts 13 & 14 Blk 10 Original Town Gayville, 100% MEETING ROOM; Lutheran Church, Lts 8 & 9 Blk 15 & Lts 8 & 9 Blk 16 Original Town Gayville, 100% PARSONAGE & CHURCH; Gayville-Volin United Methodist Church, E2 Lt 11, All Lts 12, 13 & 14 Blk 16 Original Town Gayville, 100% CHURCH; Ermie Pecena Community Center, Lts 13-15 Blk 5 & Lt 6 Blk 6 Original Town Lesterville, 100% COMMUNITY CENTER & CITY PARK CENTER; Lesterville Fire Department of Lesterville, W80' Lts 21 & 22 Blk 5 Original Town, 100% FIRE DEPT; Lesterville Community Club, Lts 17 & 18 Blk 6 Original Town Lesterville, 100% PARK AND SHELTER; St John Baptist Catholic Church, Lts 2-12 Kappel Addn Lesterville, 100% PARSONAGE; Roman Catholic Parish, Lts 1-5 Blk 1 Wagners Addn Lesterville, 100% STORAGE GARAGE; Harvest Independent Baptist Church, Outlots G & H SE4 SE4 Mission Hill Outlots, 100% RELIGIOUS; Mission Hill Cemetery Association, Outlot F SE4 SE4 Mission Hill Outlots & N474.8' Outlot 1 Mission Hill Outlots, 100% CEMETERY; Lutheran Church, Outlot J & E75' Outlot K Mission Hill Outlots, 100% CHURCH; ZCBI Lodge, Lts 16-20 Blk 6 Original Town Utica, 100% LODGE; City of Volin, Lts 1 & 2 & W11' Lt 3 Blk 13 Volin Addn, 100% FIRE DEPT; Wintz & Ray Funeral Home & Cremation Service Inc, Lt 3 Exc E187' S361.4' & Exc N92' Lt 3, All Lt 4 Blk 1 Airport Acres, 100% CEMETERY; Sacred Heart Health Services, Avera Sacred Heart Senior Living Campus Addition 14-93-56, 100% ASSISTED LIVING; Sacred Heart Hospital, Hospital Lt D & D1 Benedictine Addn, 80% WELLNESS & REHAB CTR/ 94.758% BENEDEICTINE CTR/ 81.813 % PROFESSIONAL OFFICE; Mount Marty Hospital Association, Hospital Lts A1, D2, D3, D4, & E1/2 Benedictine Hilltop Addn, 100% PARKING LOT; Benedictine Convent of the Sacred Heart, Ryken Tr 2, Ryken Tr 3 East of 1/16th line & that part of Tr 4 lying west of div line between Govt Lots 2 & 3 13-93-56 & Monastery Lts A2, B, B1, C, C1,C2,C4,C5 & F Benedictine Hilltop Addn & Monastery Lt E1 & Lts X & Y Benedictine Addn, 100% RELIGIOUS EDUCATION & Parcel 44 Parcels 13-93-56, 100% LIVING QUARTERS; Yankton Baptist Church, Lt F B.K.L Addition, 100% PARSONAGE; The Dakota Conference

2010 Legal and Public Notices
13-93-57, 100% RELIGIOUS; Polish Catholic Congregation, Parc commencing @ NE corner NE4, thence running W20rds, thence S80rds, thence E20rds, thence N80rds to POB 5-94-57, 100% CEMETERY; Public Cemetery, Parcel 104' X 792' NW4 11-94-57, 100% CEMETERY; Roman Catholic Church St Wenceslaus, Parc beginning @ pt lrd S of center of Sec 33-94-57 thence running S33rds, thence E48rds, thence N33rds, thence W48rds to POB NW4 SE4, 100% CEMETERY; St John The Baptist Church of Lesterville, Lt X NW4 NE4 21-95-57, 100% RELIGIOUS; Civil Cemetery Association, Commencing @ pt 28.5' E of quarter sec corner common to